

# Honda Civic FL5 Type R Front Catch Can Fitting Instructions

## Tools Required:

- Ratchet and Socket Set
- Jubilee Driver
- Allen Key Set
- Side Cutters
- Hose Clip Tool

## Kit Contents:

- 1x AIRTEC Motorsport Catch Can
- 1x Catch Can Bracket
- 1x Hose Bracket
- 1x Pro Hoses Hose 1
- 1x Pro Hoses Hose 2
- 1x Pro Hoses Hose 3 – Coolant Hose (small)
- 2 x Catch Can 10mm Take-off
- 2x 8mm Hose Joiners
- 1x 10mm Hose Joiner
- 2x Hose Bracket Spacers
- 2x M6x30mm Buttons
- 2x M6 Washers (15mm)
- 3x Large Cable Ties
- 3x 20mm Jubilee Clips
- 1x 30mm Jubilee Clip
- 2x 16mm Jubilee Clips

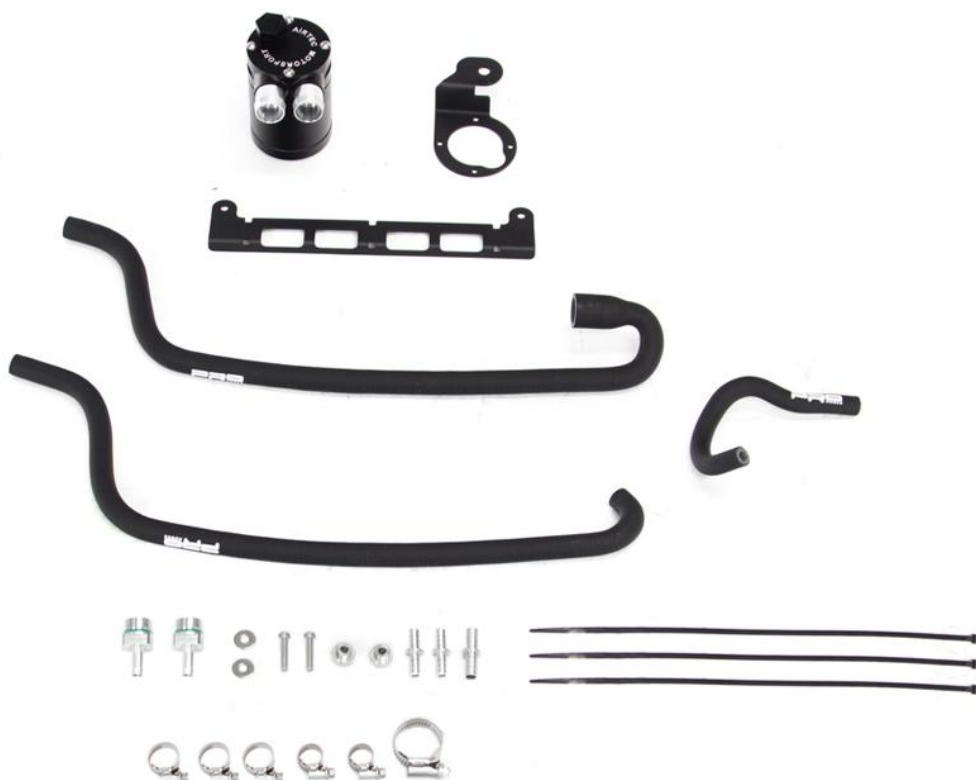

PLEASE THOROUGHLY READ THESE INSTRUCTIONS AND MAKE SURE YOU ARE FAMILIAR WITH THE STEPS BEFORE CARRYING THEM OUT

# Instructions:

1. First, remove the induction hose and plastic pipe between the induction air box and the induction cast pipe. Then, move the recirculation hoses and plastic connector out of the way.

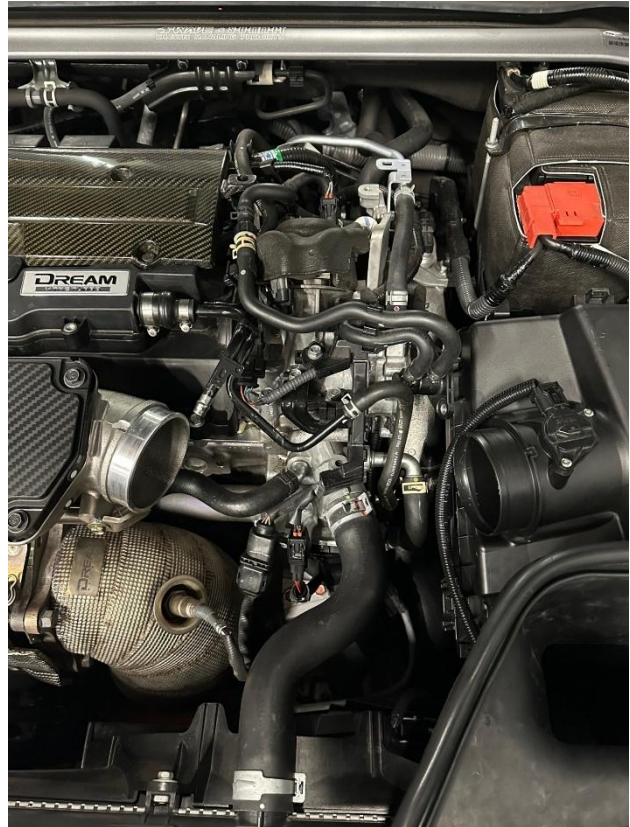
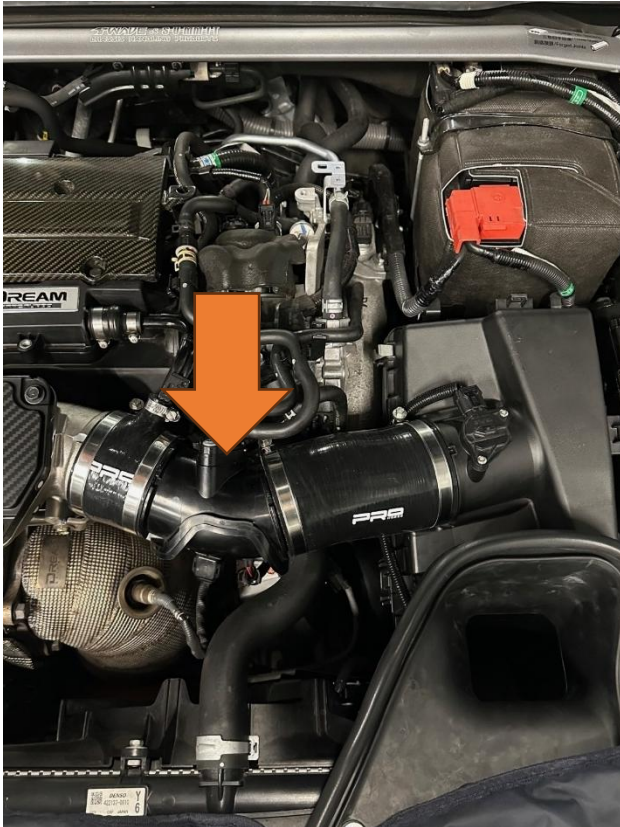

2. Locate the hard pipework for the engine breather and coolant system. Remove the jubilee clip over the engine breather outlet with a pair of sharp side cutters.

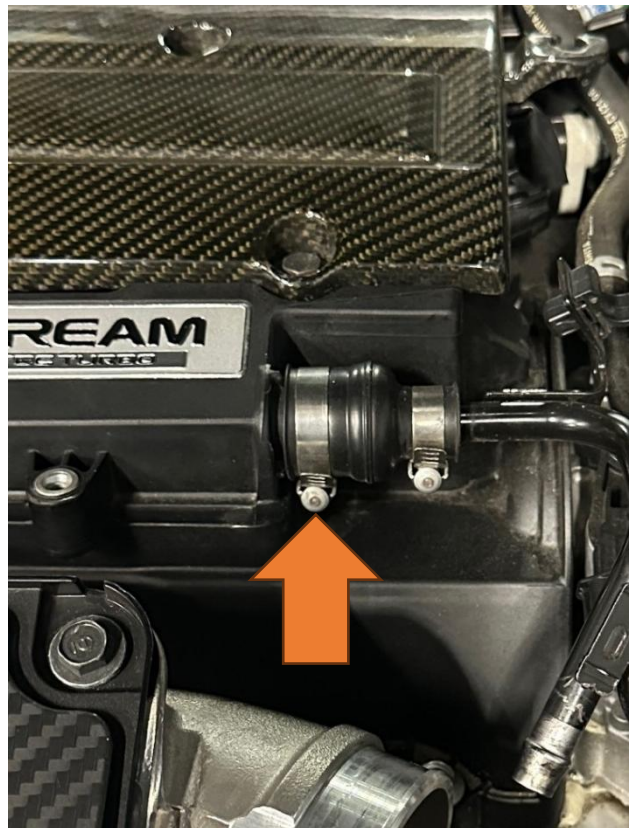
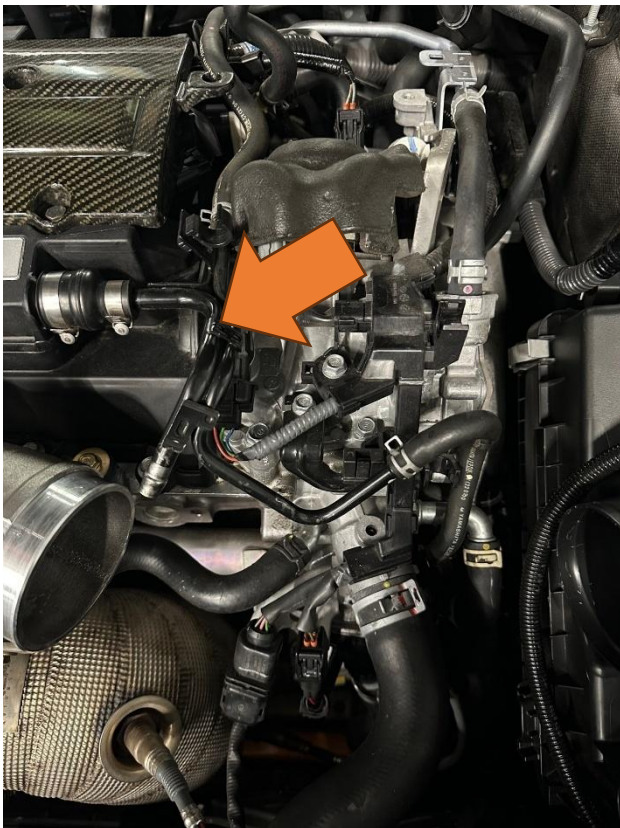



3. Prepare the small supplied silicone hose by pushing in both hose connectors provided and securing them with jubilee clips. Place an absorbing material under the hard pipe and remove both clips. Replace the hard pipe with the silicone hose and reattach the original clips. Hold it in place with a cable tie, as shown.

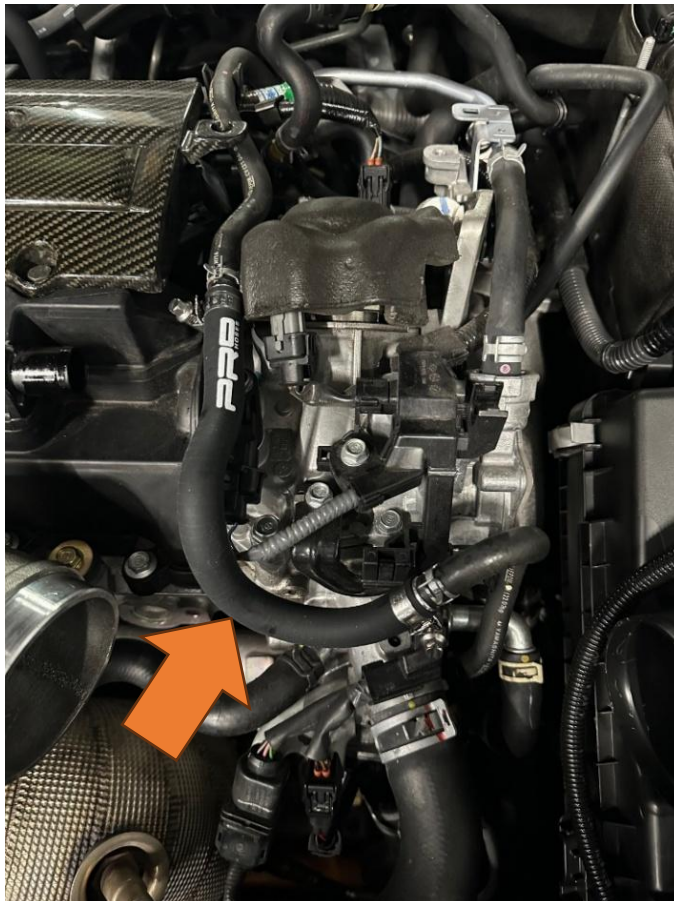
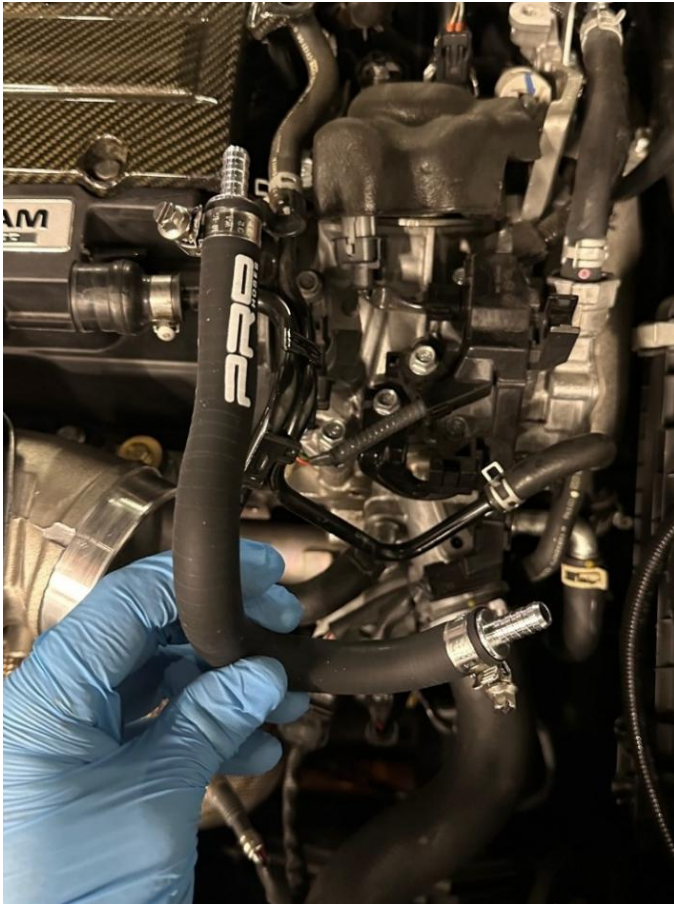



4. Locate the induction hard pipe and remove both the top left and right securing bolts. Fit the supplied billet spacers in their place and then secure the hose bracket in place with the provided bolts and washers.



5. Reinstall the induction parts removed in Step 1 and place the hose connector into the induction take-off hose, as shown. Then secure with a supplied jubilee clip.

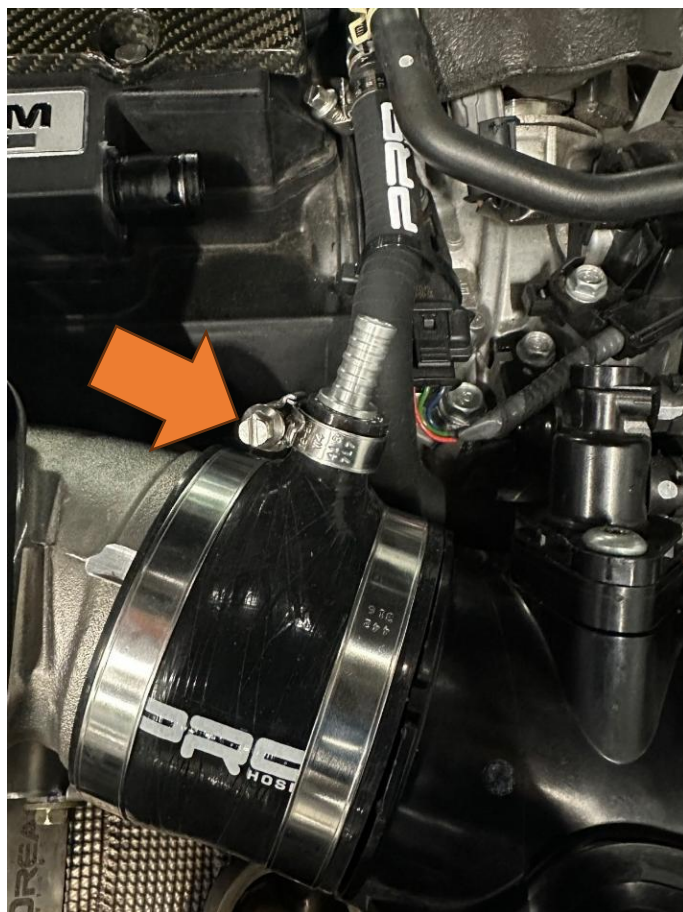
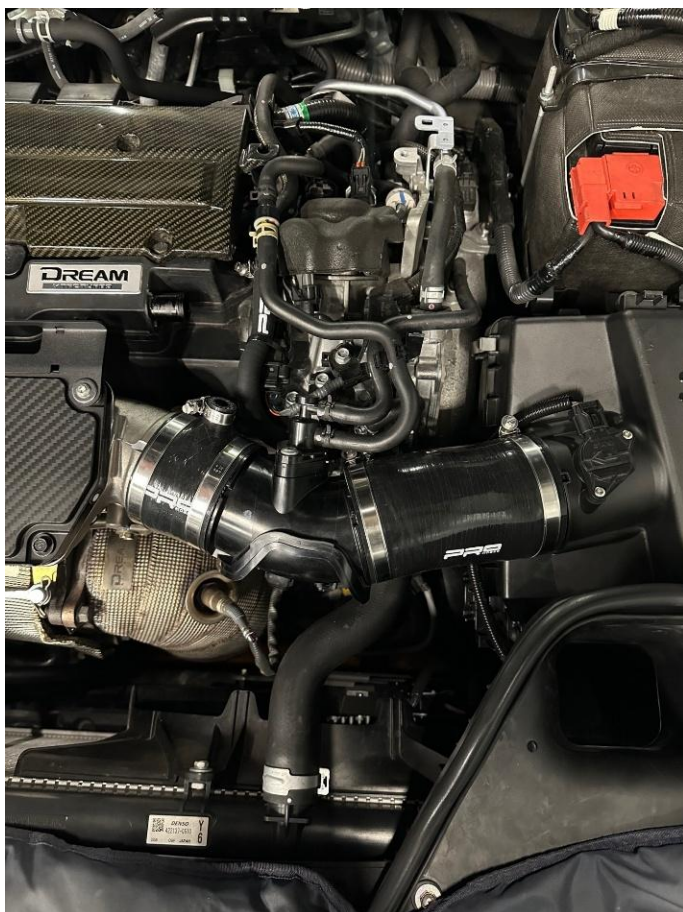



6. Prepare the AIRTEC Motorsport billet catch can by fitting the push-fit CNC connectors and mounting the powder-coated bracket, as shown. Please ensure the catch looks like the image below and the O-rings have been installed.



7. Move to the left-hand side of the engine bay and locate the engine mount. Remove the 12mm bolt, as shown. Then attach the catch can assembly in the same position, making sure the fittings are facing the engine.

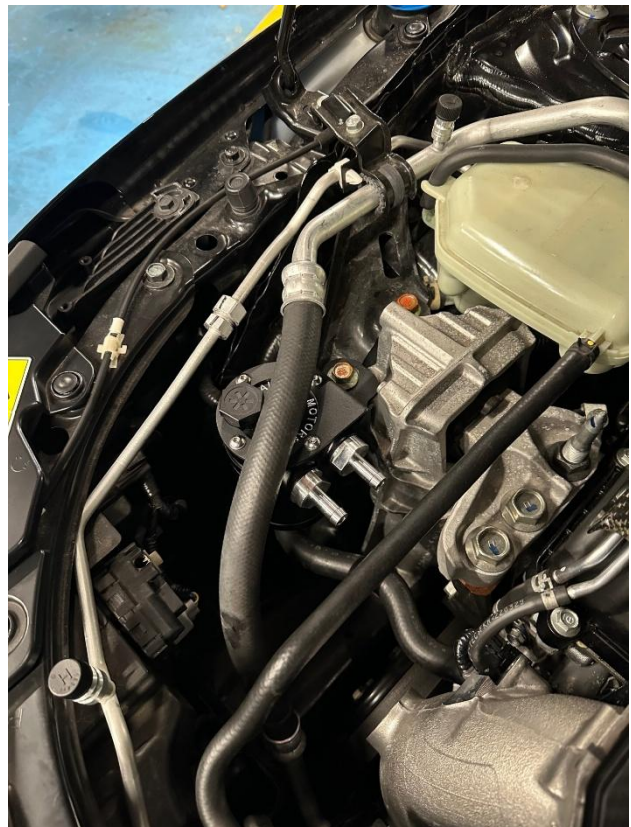



8. Place the first hose over the engine starting from the catch can and ending at the breather outlet.



9. Place the second hose in the same location and connect it to the induction hose take-off fitted in Step 5. Secure both hoses with the supplied jubilee clips.





10. Secure both hoses to the mounting bracket fitted in Step 4 using the supplied cable ties. Make sure all jubilee clips and brackets are tight.



11. Finally, check everything is tight and secure.

