

Ford Focus Mk4 ST Enclosed Induction Kit Fitting Instructions

Tools needs:

- Allen Key set
- Flat-Bladed Screwdriver/Jubilee Hose Driver
- Plastic trim removal tool

Kit includes:

- 1x AIRTEC Motorsport air box (four pieces)
- 1x AIRTEC Motorsport cotton air filter
- 1x Sensor housing pipe (with bolt and clamp)
- 15x M6x12 Button Head bolts
- 12x M6 Pan Washers
- 3x Locating Pins
- 3x M6 Mudguard Washers
- 2x M6x16 Socket Head bolts
- 2x Spacers

PLEASE THOROUGHLY READ THESE INSTRUCTIONS AND MAKE SURE YOU ARE FAMILIAR WITH THE STEPS BEFORE CARRYING THEM OUT

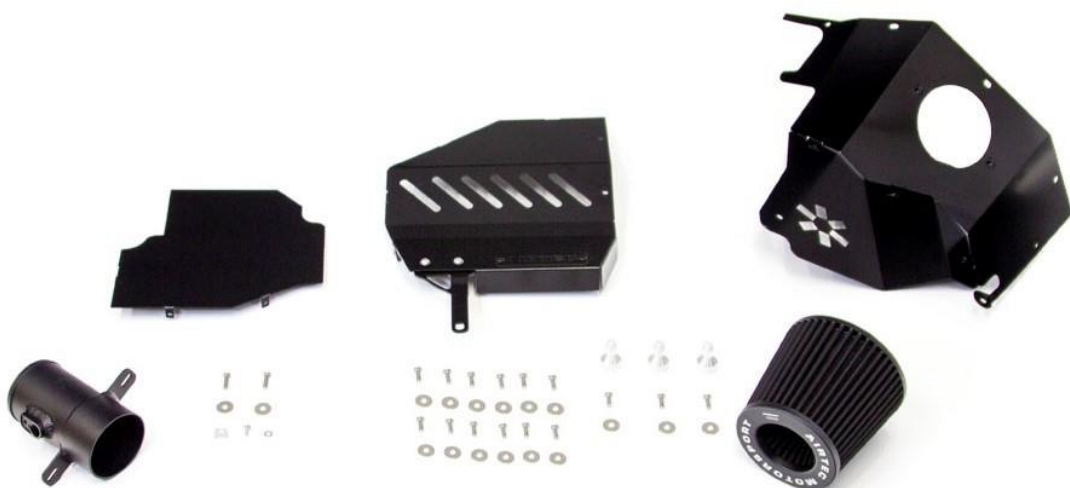

Instructions:

1. Disconnect the plug from the sensor on the side of the air box.



2. Loosen the jubilee clip and remove the hose from the air box by carefully but firmly pushing it back.



3. Disconnect the cold air feed from the air box by pushing the securing tabs using a plastic trim tool or flat-bladed screw driver. Please note: If using a flat-bladed screw driver, we recommend covering the end with masking tape to prevent scratching the air feed.



4. With the cold air feed separated, remove the standard air box by carefully but firmly pulling it up off its rubber mountings and remove from the engine bay.



5. Ensure the three rubber mountings have remained in place, as pictured. If not, check to see if they are still attached to the original air box and refit to the car.



6. Install the three locating pins to the lower piece of the air box using three of the M6 bolts and larger Mudguard washers provided.

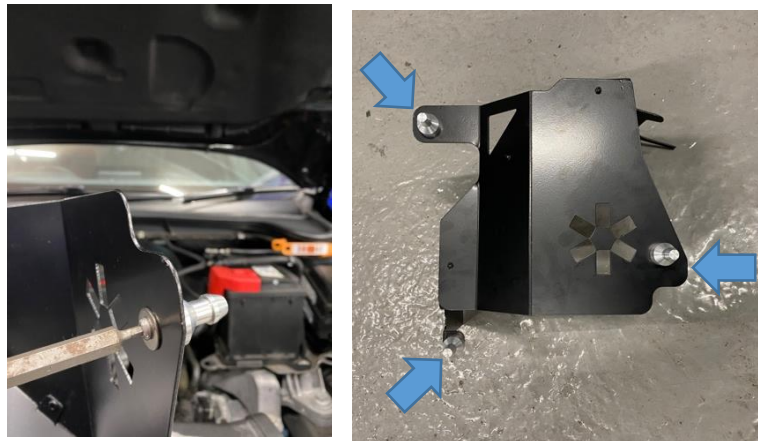

7. Attach the back piece of the air box to the lower piece using three of the M6 bolts and washers. Start with the left-hand bolt first but do not fully tighten. Then line the middle bolt up but do not fully tighten before lining the right-hand bolt in place. Once all bolts are engaged, fully tighten them.

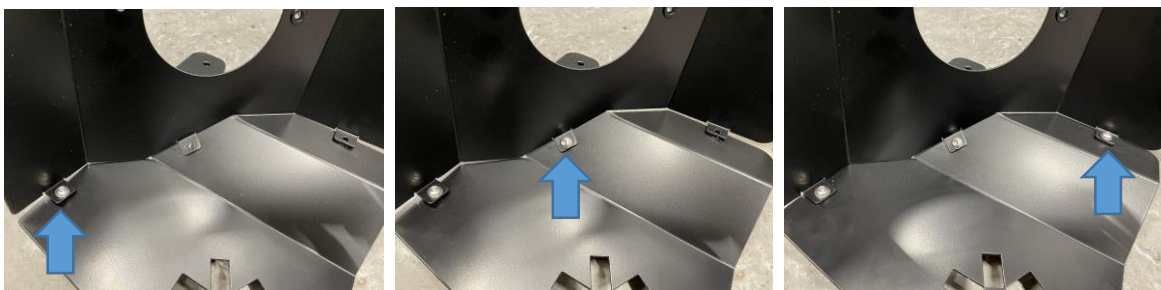

8. Attach the side piece of the air box using one M6 bolt and washer at the rear, but do not fully tighten. The air box can now be fitted by locating the three pins into the rubber mounts in Step 5 and firmly pushing them into place to ensure they engage.

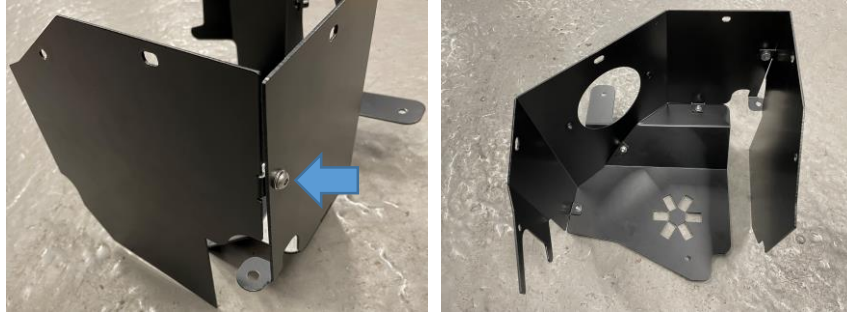

9. If the kit is being fitted with an AIRTEC Motorsport top pipe (as pictured here), install the silicone coupler that came with it and attach to the new sensor housing pipe supplied. If using a standard top pipe, attach the original intake hose and jubilee clip. Once in place, fix the pipe securely to the heat shield using the two longer Socket Head M6 bolts provided, washers and spacers, as pictured.



10. Remove the sensor from the original air box and reinstall it into the new pipe, securing it in place using the supplied bolt and clamp. Then attach your AIRTEC Motorsport air filter using the jubilee clip supplied.



11. You can now install the air box lid by aligning the tabs on the back and side pieces and fitting six of the M6 bolts and washers provided. Working from left to right, fit them loosely in place at first and when all six are engaged, fully tighten. Then tighten the M6 bolt at the rear fitted in Step 8.



12. Remove the 10mm bolt from the slam panel (as shown) and slide the AIRTEC Motorsport mounting bracket into the front of the air box and then secure in place using the provided M6 bolts and washers. You can then reinstall the 10mm bolt through the bracket into its original location.

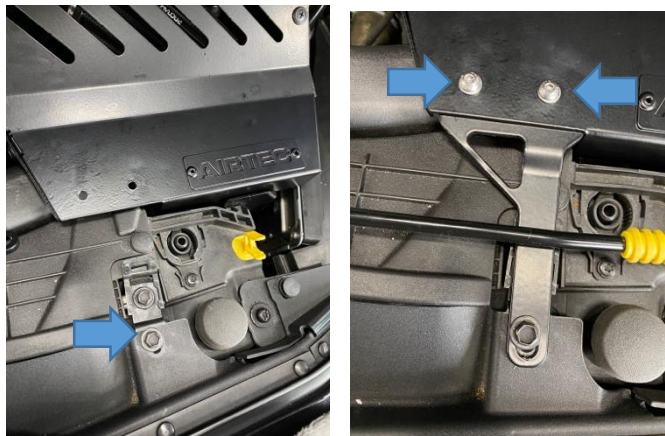

13. Finally plug the sensor wiring back in and then check that everything has been secured and tightened correctly with no fitment issues.

